

KANE

SECTOR: RETAIL & HOSPITALITY



ABOUT US



Who We Are

We are a privately owned commercial construction company active in all sectors of the industry. With a turnover in excess of \$800 million and over 400 full time employees, we operate throughout the east coast of Australia and overseas from offices in Melbourne, Sydney, Brisbane and Canberra.

‘Our success is recognised in the way we achieve, as much as what we achieve.’

People

Our greatest asset is our people.

We engage and promote those with appropriate skills, experience and technical qualifications within a 'flat and open' management structure. Graduates in building, engineering and architecture occupy project management, technical management and contract administration positions.

Careful staff selection ensures Site Managers and Foreman of the highest calibre make up the on-site teams. Teamwork, backed by effective communication systems and administration resources, ensures a highly motivated approach to the most challenging projects.

Board of Directors



Jonathan Forster
Chairman



Richard Frisina
Joint Managing Director



Tristan Forster
Joint Managing Director



Julian Hamilton
Director



Geoff Purcell
Director



David Rutter
Director



Steve Theisz
Director

Organisational Structure

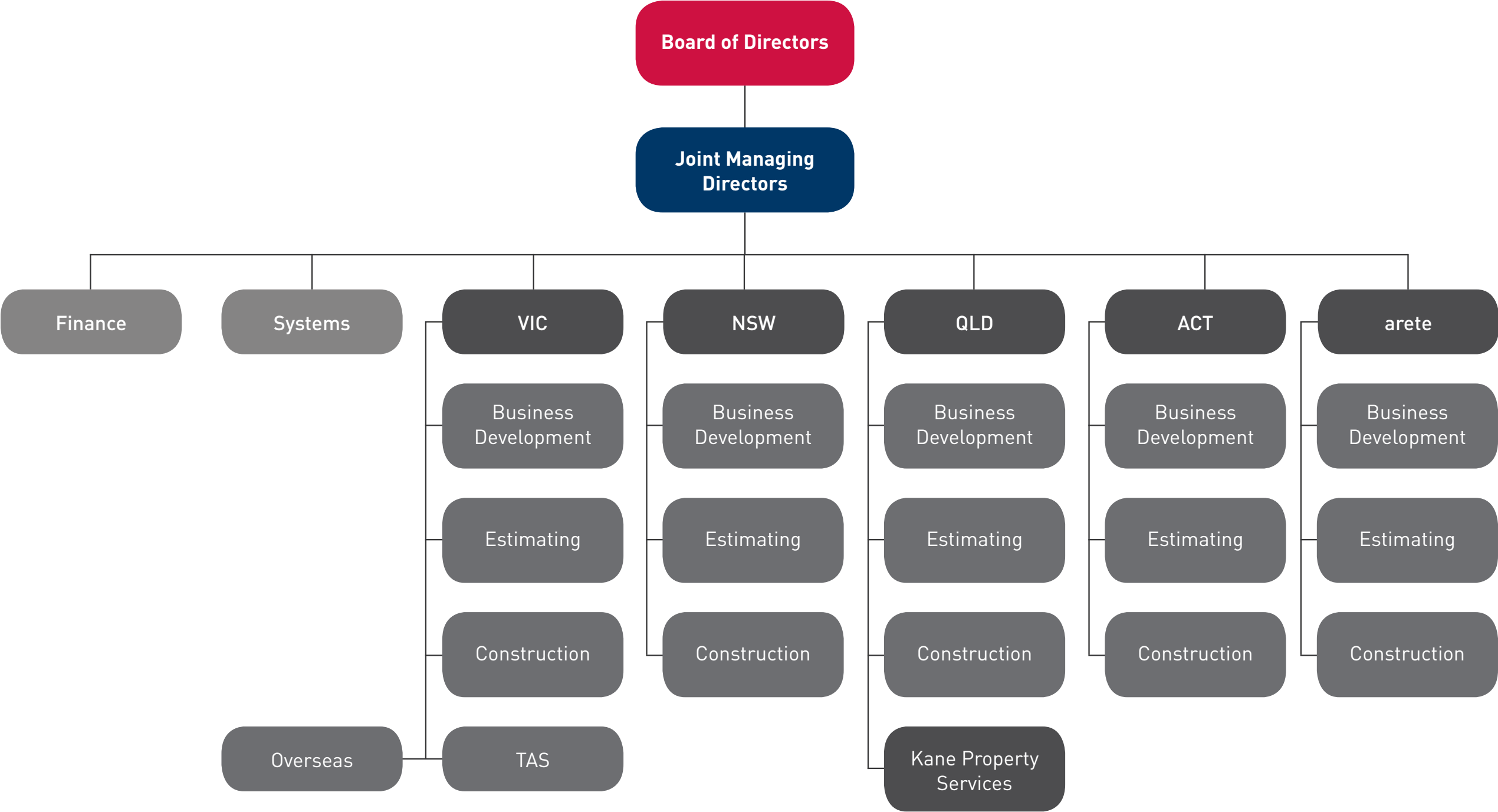

Financials

For over 40 years through the ups and downs of the building cycle, Kane Constructions has achieved steady and sustainable growth. With annual turnover in excess of \$800 million, the company is well placed to take on a mix of short, medium and longer term projects in the \$1 million to \$200 million value range.

With a strong balance sheet, no debt and significant cash reserves Kane offers its clients and their advisors financial assurance in relation to project delivery.

The construction group has total assets exceeding \$150 million with a security facility to cater for well over \$1 billion of work under construction.

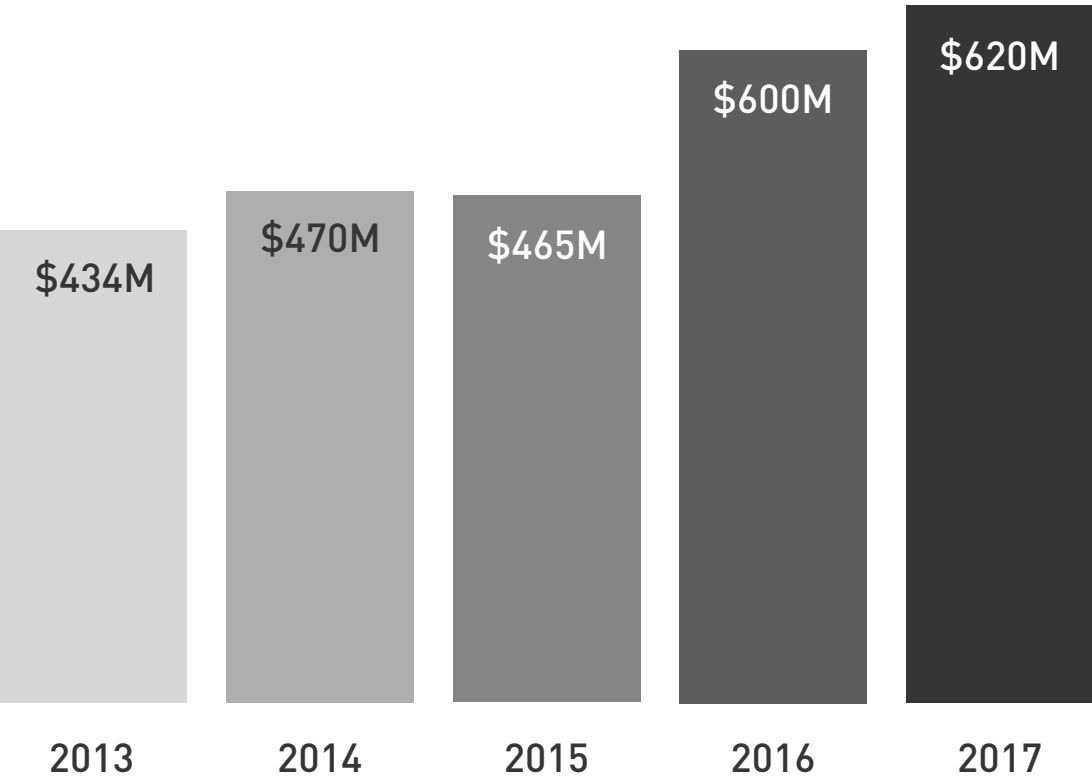

Revenue

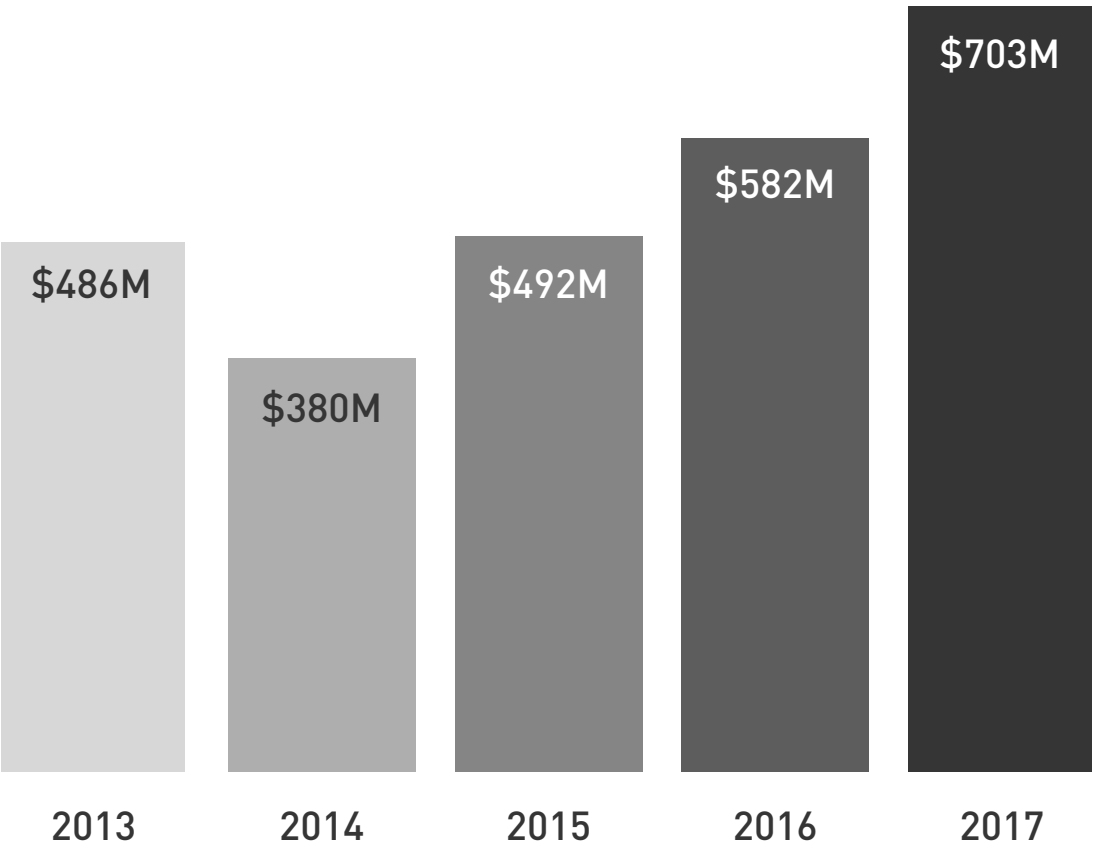

Contracts Awarded

\$815M

WORK IN HAND

44

LIVE PROJECTS

\$115M

BANK GUARANTEE /
BONDING FACILITY

\$95M

CASH ON HAND



Accreditation



Occupational Health & Safety Management
System certified to AS/NZS 4801



Quality Assurance Management System
certified to AS/NZS ISO 9001



Environmental Management System is
certified to AS/NZS ISO 14001



Australian Government Building and
Construction OHS Accreditation Scheme



National Prequalification System for Non-
Residential Building for \$50 million and above

Green Star

Project Name	State		Client	Finish
01 — University of Melbourne Arts West Redevelopment	VIC	Registered for 5 Star Green Star - Education Design v1	University of Melbourne	2016
02 — Geelong Library & Heritage Centre	VIC	5 Star Green Star - Public Building Design v1	City of Greater Geelong	2015
03 — La Trobe University Sylvia Walton Building	VIC	5 Star Green Star - Education Design v1	La Trobe University	2014
04 — GE Headquarters, Springfield	QLD	5 Star Green Star - Office Design v3	Springfield Land Corporation	2014
05 — Victoria University, Construction Futures	VIC	6 Star Green Star - Education Design v1	Victoria University	2012
06 — La Trobe Rural Health - Health Sciences Building	VIC	5 Star Green Star Education v1	La Trobe University	2012
07 — La Trobe Rural Health - Clinical Teaching Building	VIC	5 Star Green Star Education v1	La Trobe University	2012
08 — MC2 Manningham City Square	VIC	5 Star Green Star - Public Building PILOT	Manningham City Council	2012
09 — National Centre for Synchrotron Science	VIC	5 Star Green Star - Education Design v1	Australian Synchrotron	2012
10 — Kane Constructions Brisbane Office	QLD	5 Star Green Star - Office Design v3	Kane Constructions	2011
11 — Dandiiri Contact Centre Photovoltaic Array	QLD	6 Star Green Star - Office Design v2	Project Services	2011
12 — Swinburne University, Advanced Technology Centre	VIC	5 Star Green Star - Education Design v1	Swinburne University of Technology	2011
13 — Brisbane City Hall Restoration (Stage 1)	QLD	4 Star Green Star Public Building Design PILOT	Brisbane City Council	2010
14 — RMIT University Building 1	VIC	5 Star Green Star - Office Design v2	RMIT University	2010



2016 Awards



Master Builders Australia

National Commercial Master Builder of the Year
Geelong Library and Heritage Centre, National Commercial/Industrial Construction
\$20M-\$50M

Master Builders Association of Victoria

Young Builder of the Year – David Purcell

Master Builder of the Year

Geelong Library & Heritage Centre, Excellence in Construction of Commercial Buildings
\$30M-\$80M

Epworth Richmond Lee Wing Main Works, Excellence in Construction of Commercial
Buildings over \$80M

Master Builders Association of Queensland

Riverside Centre Vertical Village - Queensland Master Builders Housing & Construction
Award Commercial Building up to \$5m

National Association of Women in Construction

High Commendation - Crystal Vision Award for Advancing the Interests of Women in the
Construction Industry - Monica Fontaine

2016 Awards



Australian Institute of Building, National

Building Professional of the Year – David Purcell

Geelong Library & Heritage Centre, Professional Excellence Commercial Constructions
\$10M-\$50M

Australian Institute of Building, Victorian Chapter

Building Professional of the Year – David Purcell

Geelong Library & Heritage Centre, Professional Excellence Commercial Constructions
\$10M-\$50M

Aquanation, High Commendation Commercial Construction \$10M-\$50M

MPavilion 2015, High Commendation Research Development & Technology

Australian Institute of Architects, Victorian Chapter

Geelong Library & Heritage Centre, The Victorian Architecture Medal

Geelong Library & Heritage Centre, The Marion Mahony Award for Interior Architecture

Geelong Library & Heritage Centre, The William Wardell Award for Public Architecture

Geelong Library & Heritage Centre, The Regional Prize

2015 Awards



Master Builders Association of Victoria

Young Builder of the Year – Tim Fowler

Owen Dixon Chambers West, Excellence in Construction of Commercial Buildings
\$20M-\$30M

Australian Institute of Architects, Victorian Chapter

MPavilion, Small Project Architecture Award - Kevin Borland Award for Small
Project Architecture

RACV Torquay Resort, Commercial Architecture Commendation

La Trobe University Sylvia Walton Building, Educational
Architecture Commendation

Master Builders Association of New South Wales

Blue Mountains Theatre & Community Hub, Excellence in Construction Awards -
Refurbishment/Renovation/Extension \$15M-\$50M

2015 Awards



Australian Institute of Architects, New South Wales Chapter

Tamarama Kiosk & Services Building, Urban Design - Lloyd Rees Award

Master Builders Association of Queensland

GE Headquarters Base Building & Integrated Fitout, Springfield, Excellence in Construction Awards - Commercial Buildings over \$5M

National Trust Queensland

Anzac Square Restoration Stage 2, Conservation Works, Gold

Queensland Rail's Roma Street Station Stage 1 Roof Restoration, Conservation Works, Gold

Government House Equitable Access, Highly Commended



Social & Community

Work hard. Play hard. Give something back.



WHERE WE OPERATE



Where We Operate

We operate throughout the east coast of Australia and overseas from offices in Melbourne, Sydney, Brisbane and Canberra.

Our head office is located in Melbourne from where we service both our metropolitan projects and our regional operations. Tasmania is also resourced from the Melbourne office.

Projects in New South Wales and the Australian Capital Territory are resourced from our Sydney and Canberra offices. Regional work is undertaken primarily along the north and south coast.

From our Brisbane office we service the Sunshine Coast and the Gold Coast. We have also delivered projects in Rockhampton and as far west as St George.

We have completed a range of International projects primarily for AusAID, Department of Foreign Affairs and Trade and Department of Defence.



Melbourne

- | | | | |
|---------------|----------------|----------------|----------------|
| 1 Nhill | 9 Ballarat | 17 Echuca | 25 Moe |
| 2 Hamilton | 10 Maryborough | 18 Portsea | 26 Tidal River |
| 3 Horsham | 11 Torquay | 19 Sorrento | 27 Morwell |
| 4 Mildura | 12 Geelong | 20 Puckapunyal | 28 Ararat |
| 5 Warrnambool | 13 Castlemaine | 21 Mornington | 29 Wangaratta |
| 6 Hopetoun | 14 Bendigo | 22 Cobram | 30 Sale |
| 7 Ararat | 15 Rochester | 23 Warragul | 31 Numerkah |
| 8 Swan Hill | 16 Queenscliff | 24 Leongatha | |



Victoria

New South Wales and
Australian Capital Territory



1

3

2

6

4

5

1

2

3

4

5

6

- Orange
- Wollongong
- Menangle
- Newcastle
- Port Macquarie
- Jervis Bay

Sydney

Canberra



Brisbane

- 1 St George
- 2 Rockhampton
- 3 Toowoomba
- 4 Sunshine Coast
- 5 Gold Coast
- 6 Dalby
- 7 Mt Tamborine
- 8 Mitchell

Queensland

Tasmania



- 1 Launceston
- 2 Hobart
- 3 Fort Direction

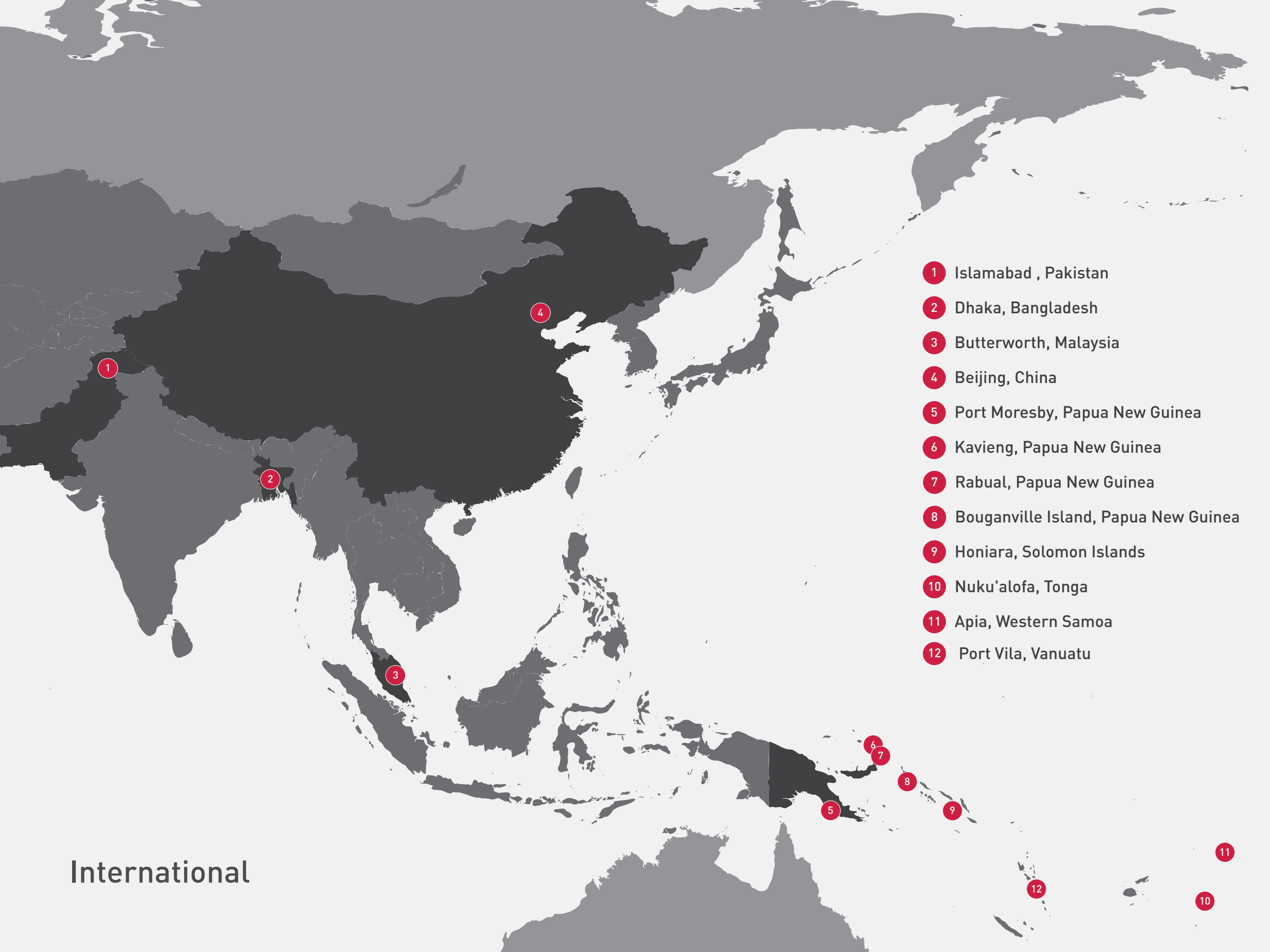

- 1 Islamabad , Pakistan
- 2 Dhaka, Bangladesh
- 3 Butterworth, Malaysia
- 4 Beijing, China
- 5 Port Moresby, Papua New Guinea
- 6 Kavieng, Papua New Guinea
- 7 Rabual, Papua New Guinea
- 8 Bouganville Island, Papua New Guinea
- 9 Honiara, Solomon Islands
- 10 Nuku'alofa, Tonga
- 11 Apia, Western Samoa
- 12 Port Vila, Vanuatu

International



PROJECTS & PEOPLE

Projects & People

The following sections provide a selection of projects delivered by Kane Constructions. Since commencing operations in 1973 we have completed over 1800 jobs across all sectors of the industry ranging in value from under \$1 million to over \$180 million.

We are proud of our work, which has been delivered in collaboration with our clients, design consultants, subcontractors and suppliers.

More importantly, our body of work could not have happened without great people.



Projects & People

Kane staff are trained and empowered to take on new challenges and fulfil their potential. Professionalism, competence, integrity and enjoying what we do are the foundations of our culture; we know our business and believe in ourselves.

In an industry where transience is common, at Kane, great value is placed on long term employment and the sharing of experience.

Years of service	5+	10+	20+
Number of people	129	62	22
Percentage	51%	25%	9%

Work by Sector

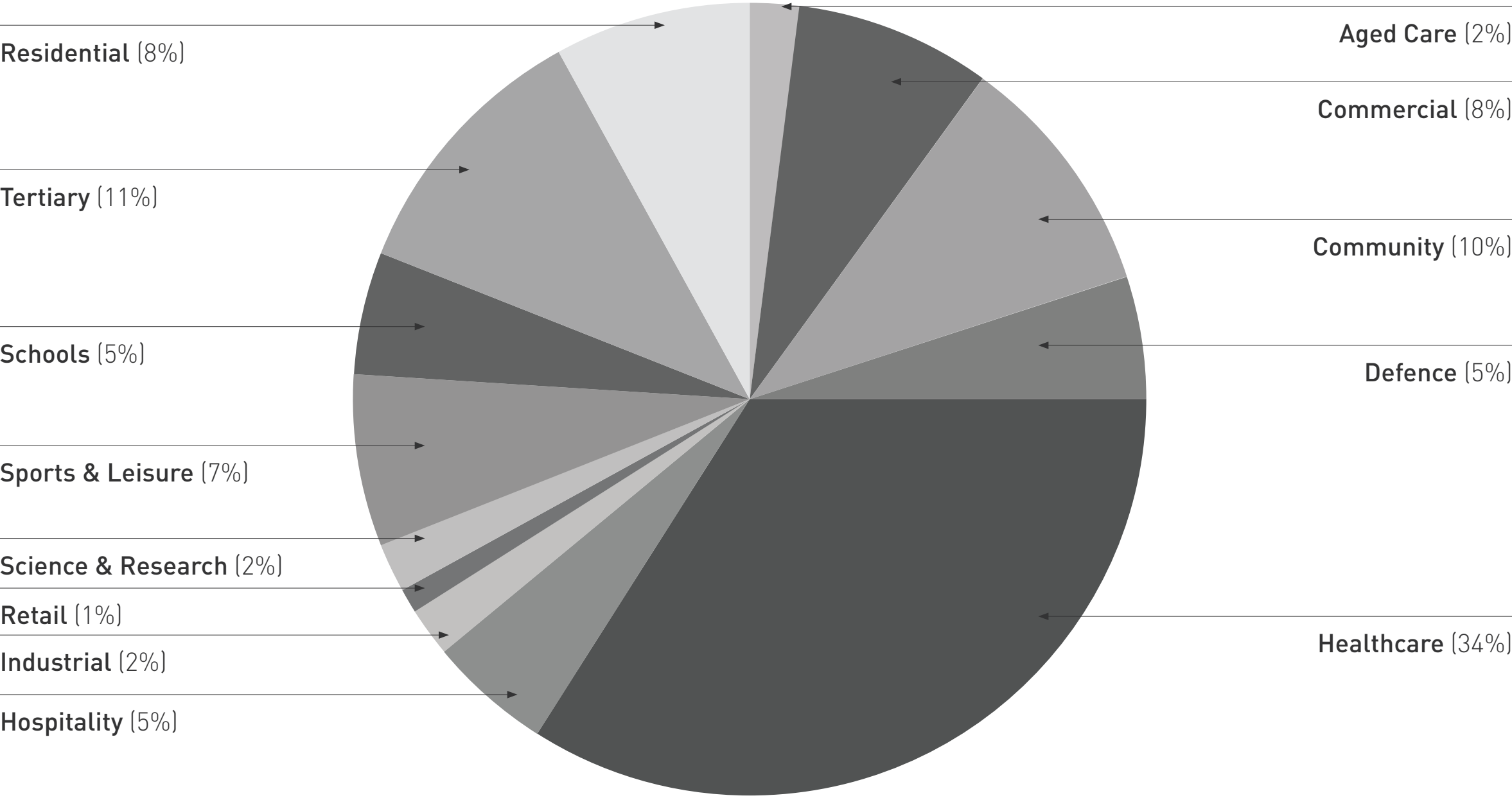

Timeline

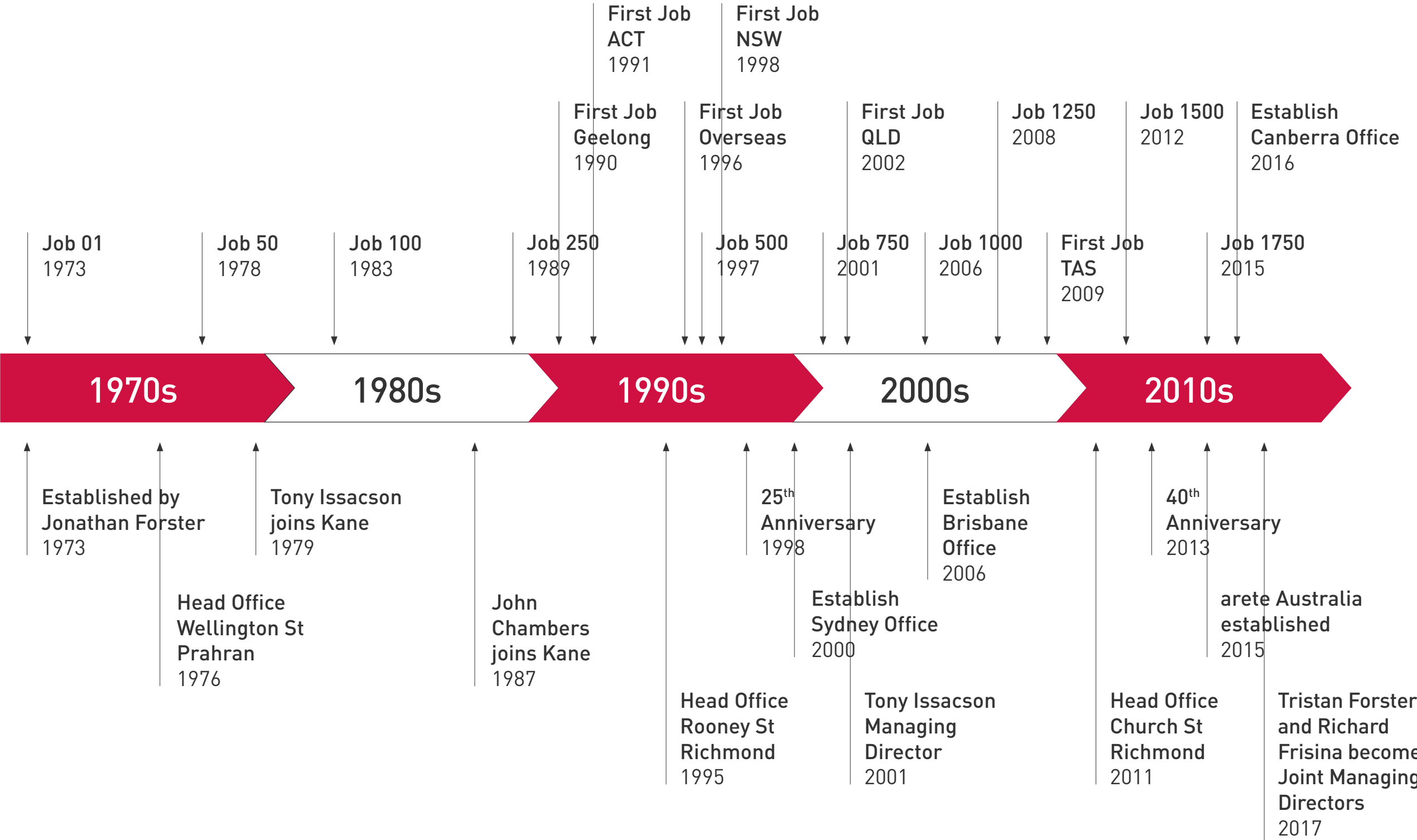

PROJECTS

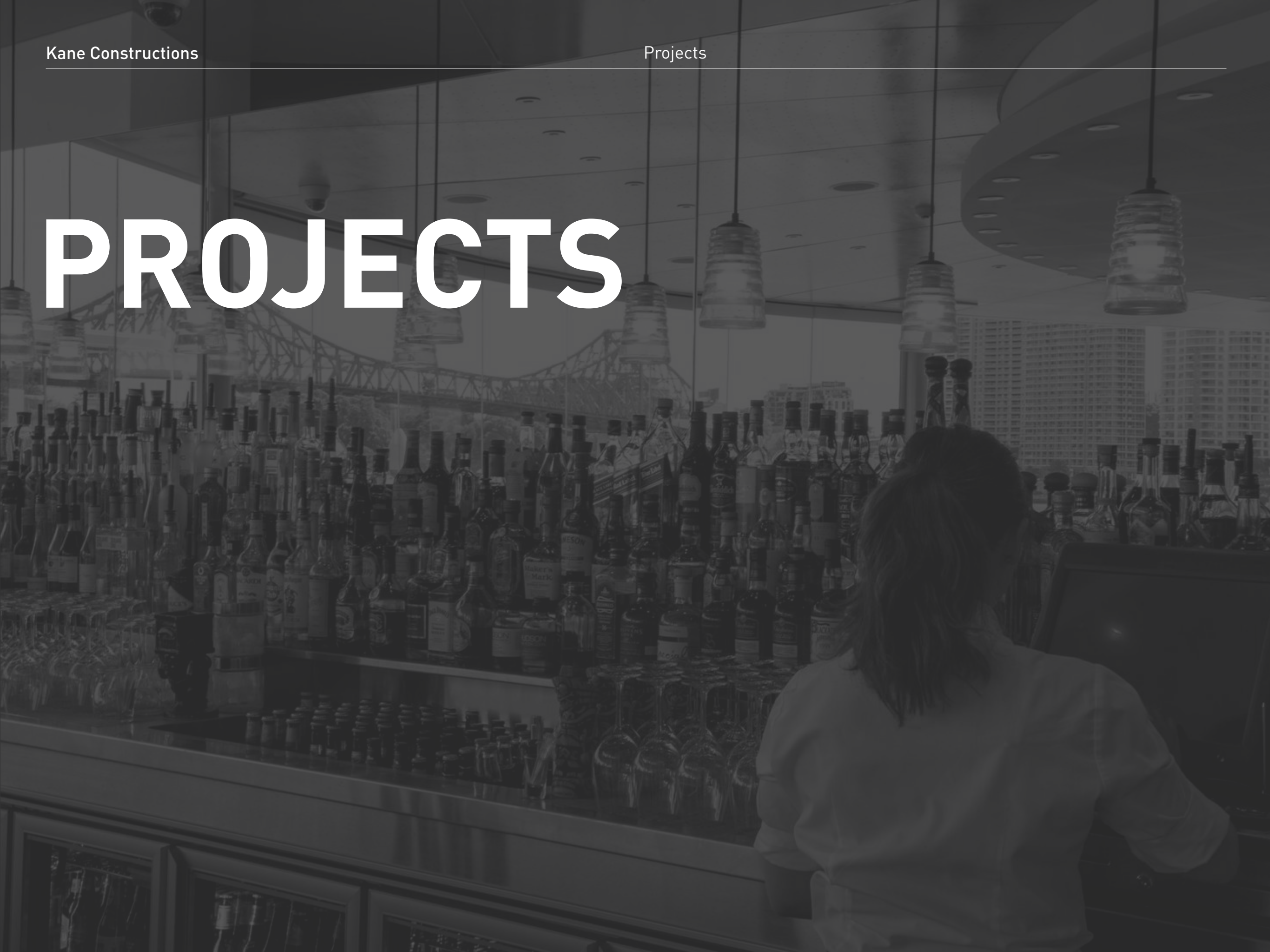

RETAIL / HOSPITALITY

Job Number: 1908 / 2017

Name: Health City One

Client: Springfield Land Corporation

Team: Deicke Richards / ADG Engineers /
BCA Consultants

Location: Queensland

Value: \$18m



RETAIL / HOSPITALITY

Job Number: 1786 / 2018

Name: Cape Schanck Resort

Client: RACV

Team: Wood Marsh

Location: Victoria

Value: \$135m





RETAIL / HOSPITALITY

Job Number: 1763 / 2016

Name: RACV Royal Pines Resort
Children's Pool & Waterpark

Client: RACV

Team: Ocean Park Consulting

Location: Queensland

Value: \$4m



RETAIL / HOSPITALITY

Job Number: 1748 / 2015

Name: Cold Rock

Client: Cold Rock

Team: Alto Architects

Location: Queensland

Value: \$1m





RETAIL / HOSPITALITY

Job Number: 1730 / 2015

Name: Journeys Kitchen & Bar

Client: Journeys Kitchen & Bar

Location: Queensland

Value: < \$1m



RETAIL / HOSPITALITY

Job Number: 1698 / 2015

Name: Lilian's Café, St Vincent's Hospital

Client: Zouki

Team: Red Design Group

Location: Queensland

Value: < \$1m



RETAIL / HOSPITALITY

Job Number: 1612 / 2013

Name: Royal Pines Resort One Spa

Client: RACV

Team: Accuraco / Peddle Thorp Architects

Location: Queensland

Value: \$7m

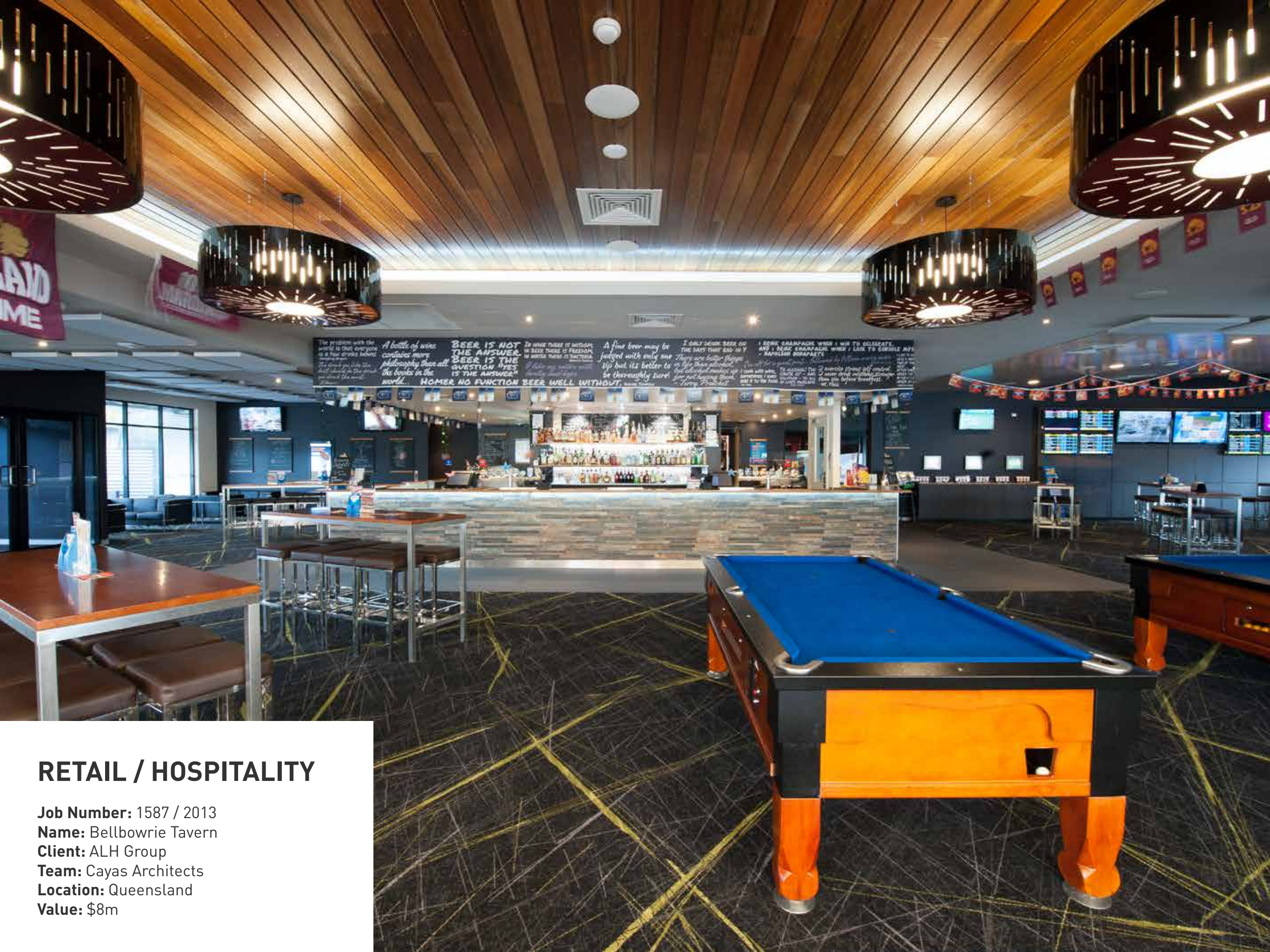

RETAIL / HOSPITALITY

Job Number: 1587 / 2013

Name: Bellbowrie Tavern

Client: ALH Group

Team: Cayas Architects

Location: Queensland

Value: \$8m

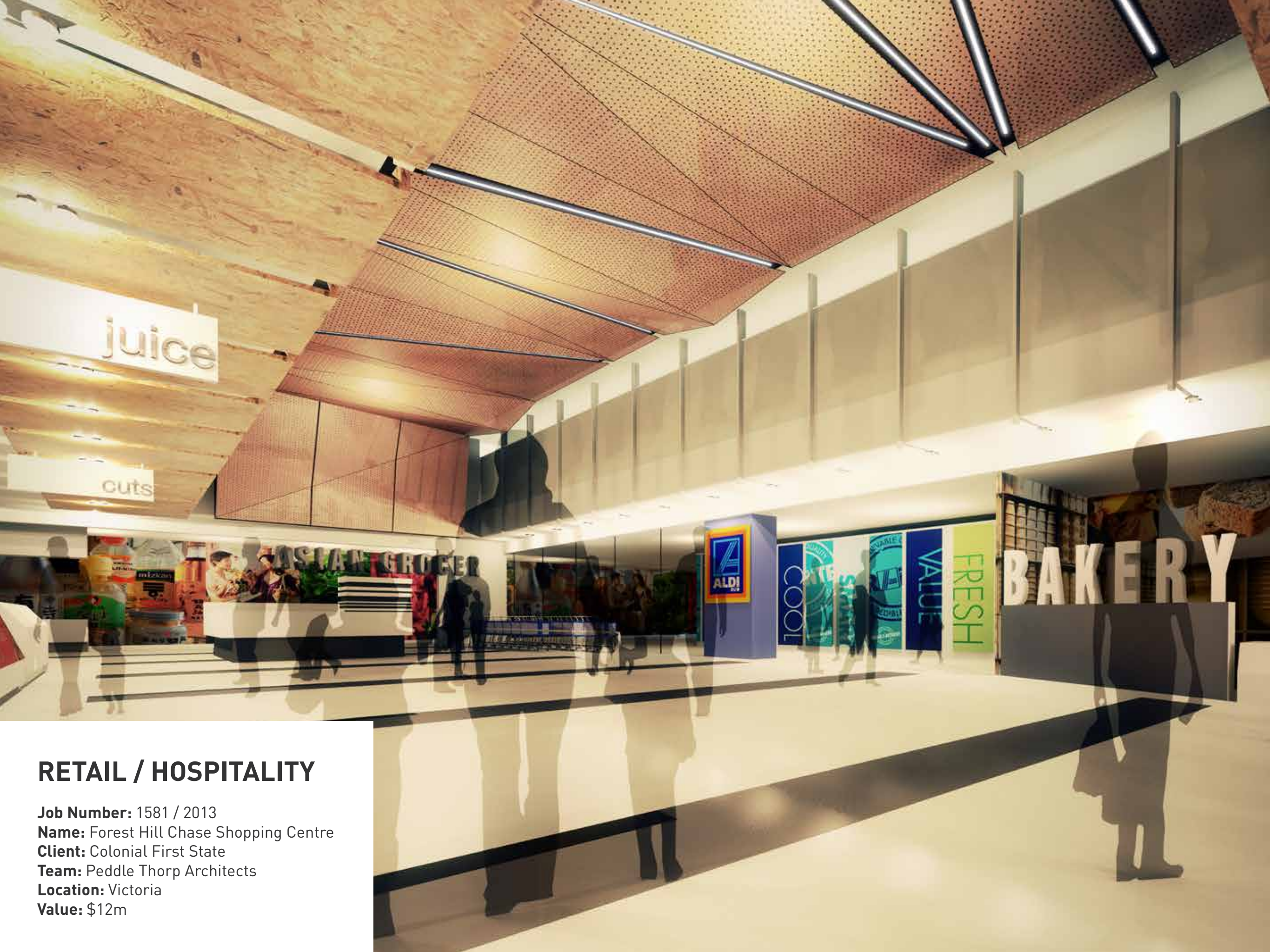

RETAIL / HOSPITALITY

Job Number: 1581 / 2013

Name: Forest Hill Chase Shopping Centre

Client: Colonial First State

Team: Peddle Thorp Architects

Location: Victoria

Value: \$12m



RETAIL / HOSPITALITY

Job Number: 1557 / 2012

Name: Il Centro Bar and Awning Works

Client: Stockland

Team: POWE Architects

Location: Queensland

Value: \$2m

RETAIL / HOSPITALITY

Job Number: 1508 / 2011

Name: User Accommodation Building

Client: Australian Synchrotron

Team: Architectus

Location: Victoria

Value: \$30m



RETAIL / HOSPITALITY

Job Number: 1500 / 2013

Name: Torquay Resort

Client: RACV

Team: Coffey Projects / Wood Marsh

Location: Victoria

Value: \$115m



RETAIL / HOSPITALITY

Job Number: 1347 / 2011

Name: Number 8

Client: GLG Developments

Team: Clarke Hopkins Clarke

Location: Victoria

Value: \$22m





RETAIL / HOSPITALITY

Job Number: 1341 / 2010

Name: Novotel on Collins

Client: Thakral Group

Team: Sweet Group /
Perrot Lyon Mathieson

Location: Victoria

Value: \$25m



RETAIL / HOSPITALITY

Job Number: 1341 / 2010
Name: Australia on Collins
Client: Thakral Group
Team: Sweet Group /
Perrot Lyon Mathieson
Location: Victoria
Value: \$3m



RETAIL / HOSPITALITY

Job Number: 1329 / 2009

Name: The Residence, Grand Hyatt

Client: Grand Hotels Group

Team: Nash Management /
Graphos Architects

Location: Victoria

Value: \$7m

RETAIL / HOSPITALITY

Job Number: 1267 / 2009

Name: Sandringham Yacht Club

Client: Sandringham Yacht Club

Team: Richard Mabin Architecture

Location: Victoria

Value: \$10m





RETAIL / HOSPITALITY

Job Number: 1266 / 2008

Name: Guiseppe Arnaldo & Sons

Client: Crown Limited

Team: Lazzarini Pickering Architetti

Location: Victoria

Value: \$5m





RETAIL / HOSPITALITY

Job Number: 1258 / 2008

Name: Grand Hyatt Melbourne

Client: Grand Hotels Group

Team: Billard Leece Partnership

Location: Victoria

Value: \$20m

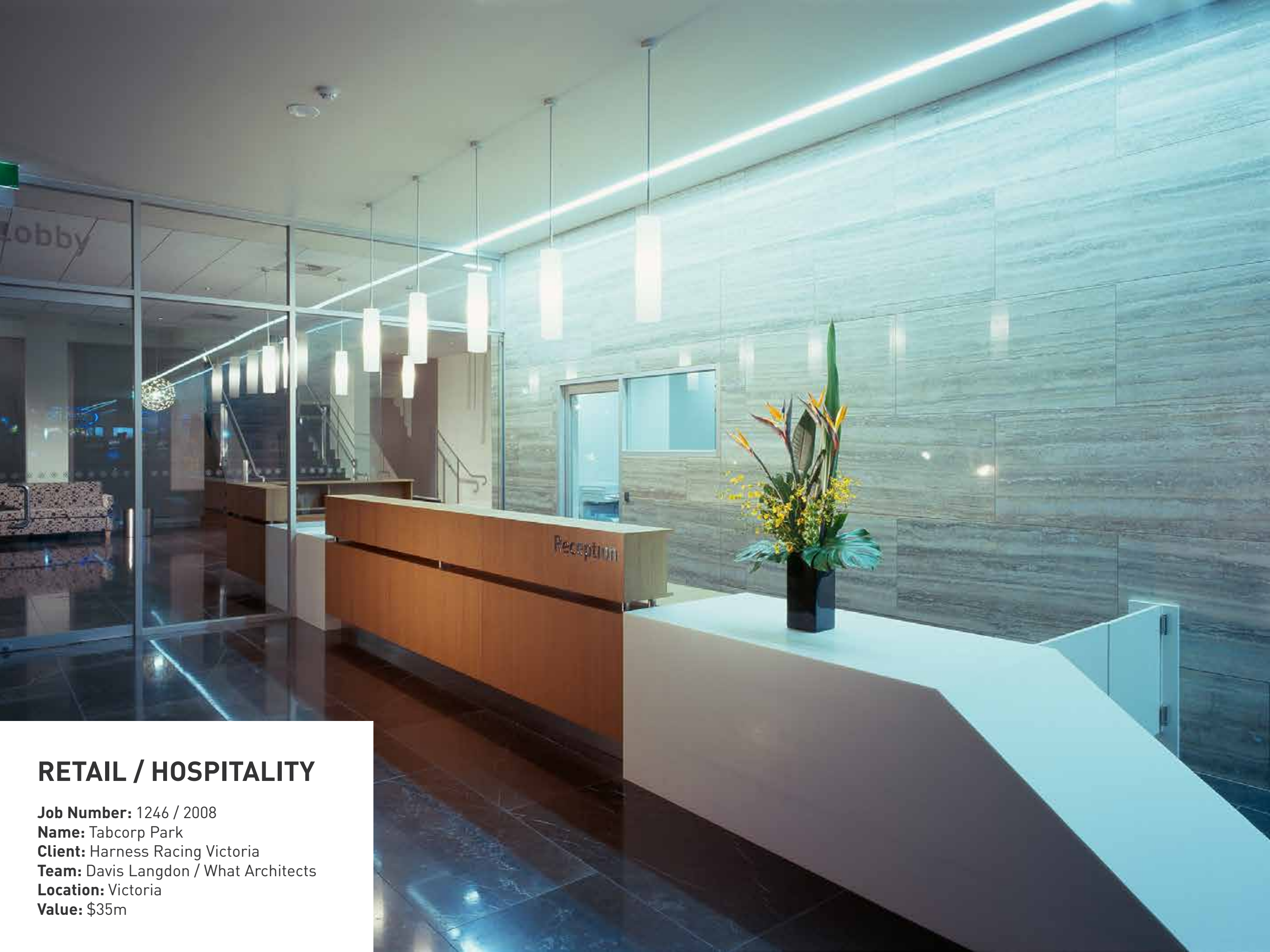

RETAIL / HOSPITALITY

Job Number: 1246 / 2008

Name: Tabcorp Park

Client: Harness Racing Victoria

Team: Davis Langdon / What Architects

Location: Victoria

Value: \$35m

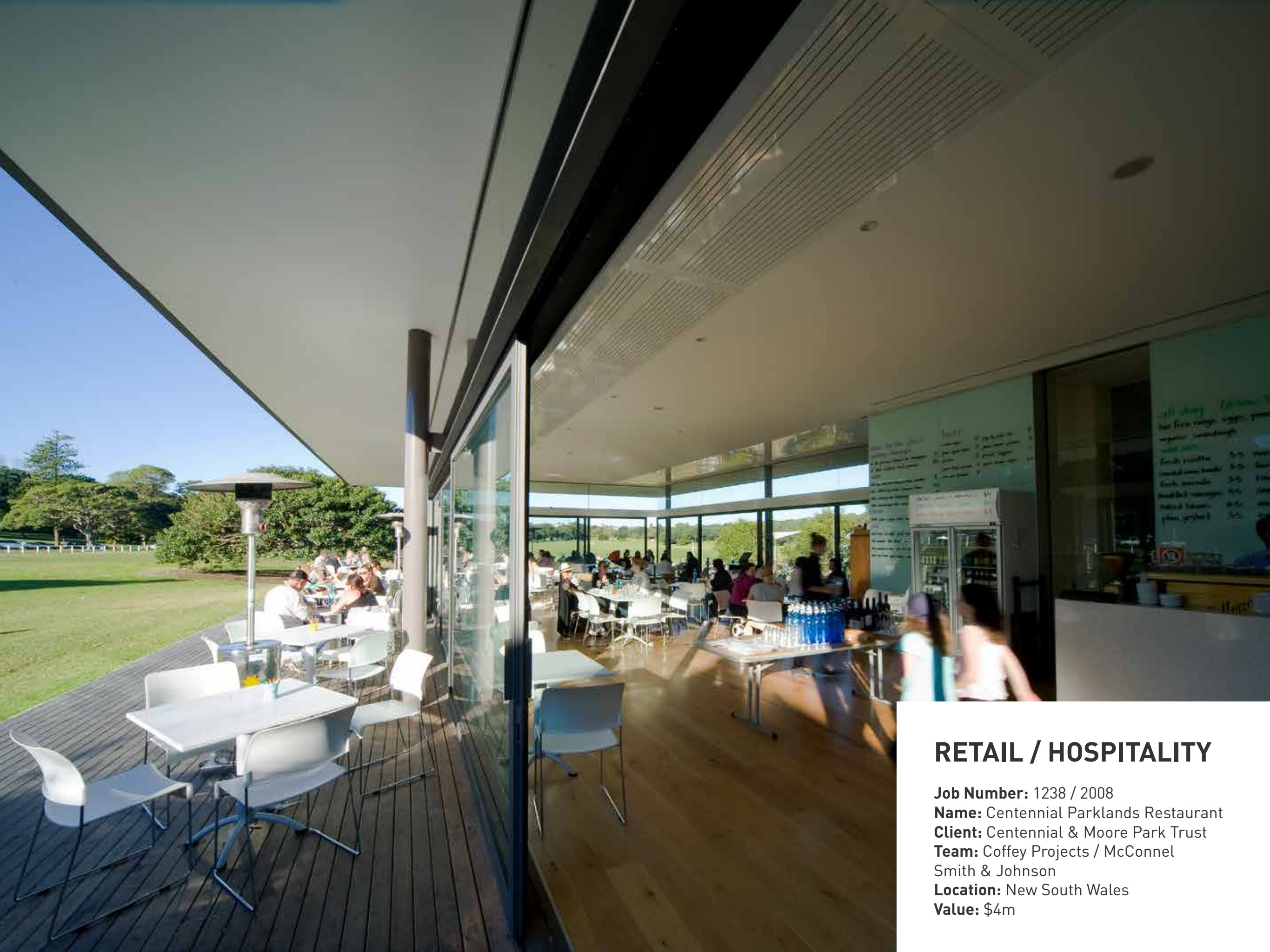

RETAIL / HOSPITALITY

Job Number: 1238 / 2008

Name: Centennial Parklands Restaurant

Client: Centennial & Moore Park Trust

Team: Coffey Projects / McConnel
Smith & Johnson

Location: New South Wales

Value: \$4m



RETAIL / HOSPITALITY

Job Number: 1193 / 2007

Name: City Club

Client: RACV

Team: Davis Langdon / Peddle Thorp Architects

Location: Victoria

Value: \$12m



RETAIL / HOSPITALITY

Job Number: 582 / 1998

Name: Kerferd Road Kiosk

Client: Kerferd Road Catering

Team: Peter Mills and Associates

Location: Victoria

Value: \$1m



RETAIL / HOSPITALITY

Job Number: 642 / 2000

Name: BMW South Yarra

Client: Bib Stilwell BMW

Team: ERA 2000 Architects

Location: Victoria

Value: \$4m



RETAIL / HOSPITALITY

Job Number: 862 / 2002

Name: Mini Dealership

Client: Col Crawford Motors

Team: Humel Architects

Location: New South Wales

Value: \$4m





RETAIL / HOSPITALITY

Job Number: 479 / 1996

Name: Carlton Brewhouse

Client: Carlton United Breweries

Team: James W Sadler

Location: Victoria

Value: \$4m



RETAIL / HOSPITALITY

Job Number: 450 / 1996

Name: The Point Restaurant

Client: Private

Team: Maddison Architects

Location: Victoria

Value: \$3m



RETAIL / HOSPITALITY

Job Number: Various

Name: ALDI Stores

Client: ALDI Stores

Team: Various

Location: Victoria

Value: \$40m+

Kane Constructions

kane.com.au

VICTORIA

Jonathan Angelopoulos

0430 369 499

jange@kane.com.au

NEW SOUTH WALES

Brett Moore

0402 791 208

bmoore@kane.com.au

QUEENSLAND

Lauri Hitzke

0447 231 838

lhitzke@kane.com.au

AUSTRALIAN CAPITAL TERRITORY

Ben Barrett

0417 014 542

bbarrett@kane.com.au