



ROYAL AUTO
RA

JULY 2013

- | WIN a cruise with our reader survey
- | Save dollars on your driving
- | Goulburn Valley gourmet drive

BOLD & BEAUTIFUL

Welcome to the stunning RACV Torquay Resort

RACV

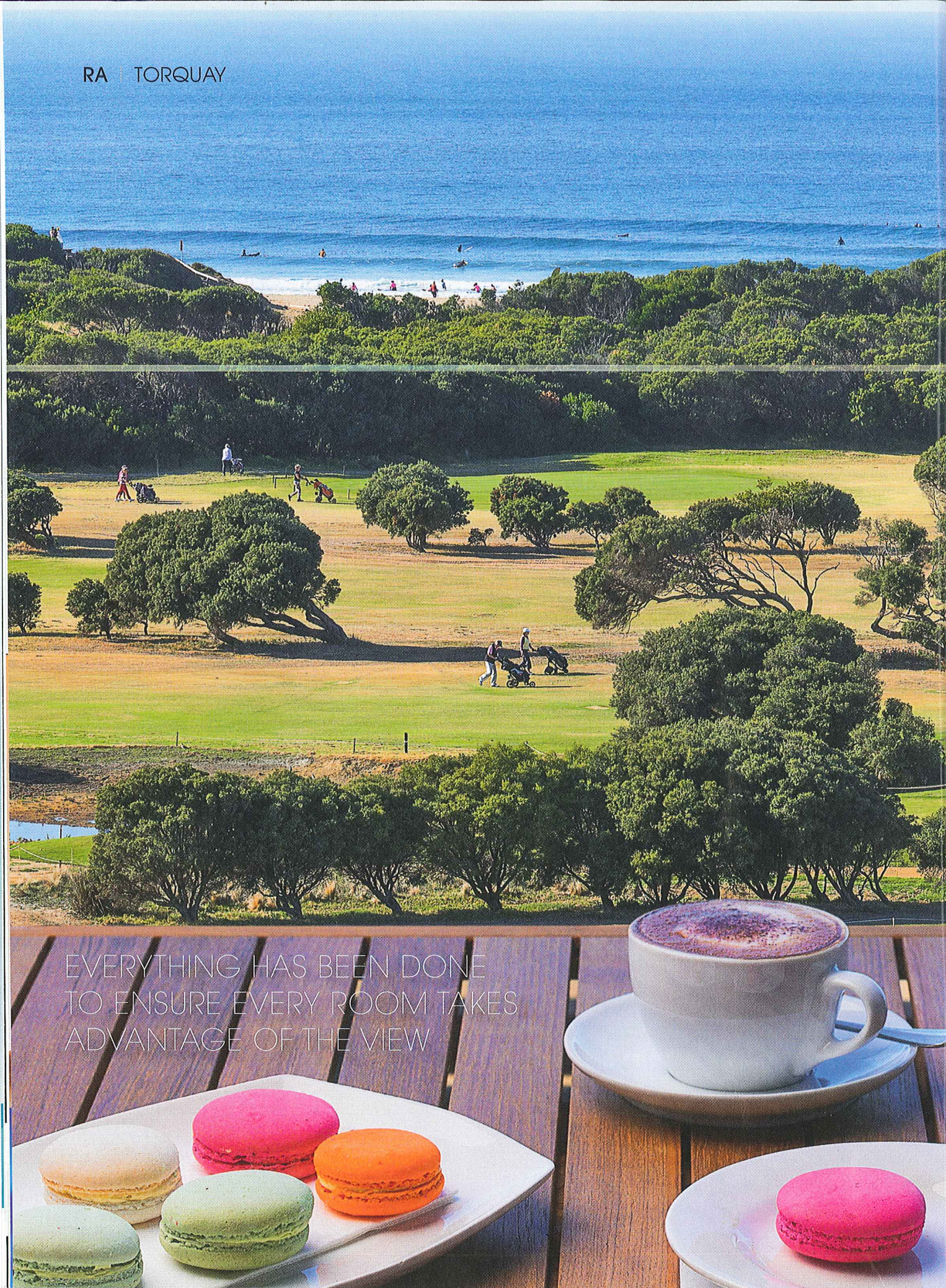

THE NEW NUMBER ONE

RACV's new Torquay Resort is a statement of quality and design that brings member value to Victoria's most iconic address, No. 1 Great Ocean Road. Story: Jenny Brown. Main photos: Michael McLeod.

The Great Ocean Road, one of Australia's most important tourism destinations, now has an exciting new attraction. RACV's newest resort has taken shape as a remarkable statement of curvaceous, earthy architecture. Its design, its setting in an undulating golf course in the dunes of the Torquay coast, and its overtly crafted materiality will no doubt see it become an iconic building. Aside from any other distinction, the resort is already the largest rammed earth building in Australia.

The \$115 million 92-room RACV Torquay Resort, which includes spa and wellness facilities, a conference and function centre, and the club rooms of the Torquay Golf Club, is the latest in the portfolio of RACV resorts that represents even more value for your membership.

And its address – No. 1 Great Ocean Road – places it firmly at the head of one of Australia's greatest tourist regions, and brings RACV's resort experience within easy reach of members in the western half of the state.

It was designed by the multi-award-winning firm of Wood Marsh – known as the “rock stars of architects”. The resort's form, according to Wood Marsh co-principal Roger Wood, was directly inspired by its location.

“We wanted the building to reference back to the landscape

... to be embedded in the landscape. The form of the interlocking arcs is what you see when you look out at the dune system. It's also like a softly eroding coastal cliff.”

RACV Torquay Resort is a sequence of concave, convex and converging curves that follow the contours of the site for 170m to become an elongated structure that, unusually, “seems to be part of the landscape rather than sitting on top of it”, Roger says.

It's also a building to enhance the display of more than 150 works of art, which were selected with the guidance of the Ian Potter Museum of Art in Melbourne. RACV made a significant commission with acclaimed Barwon Heads photographer Stephen Wickham, and 135 of his striking underwater photographs hang in the accommodation rooms. And the public areas are adorned with the work of some of Australia's best contemporary and Aboriginal artists.

The accommodation is set over five levels. All rooms and suites have fantastic outlooks to the coast, the entrance to Port Phillip and, on the far horizon, to Arthur's Seat.

“Everything has been done to ensure that every room could take advantage of the view,” Roger Wood says.

Resort manager Dean Newell agrees. “From every aspect it is a stunning property. The views never get old.”

The entry to the lobby immediately opens to views over the

THIS REGION IS A GOLDMINE OF PRODUCE. WE WILL BE CONCENTRATING ON SIMPLE, AMAZING FLAVOURS.

golf course, the sand hills and the big sky. The ceiling, a curtain-like draped arrangement of pale battened timbers, is one more aspect of the sinuous, supple, structural language.

Wood Marsh co-principal Randal Marsh admits that rammed earth walls are an unusual material for a commercial building. But they are a wonderful canvas for all the other materials and finishes – American oak floors, pure wool carpets, marble in the spas and steam rooms, and pastel washes from coloured glass in the window portals that line the ever-curving corridors. They ensure the building will meld into its environment with an elegance that will continue to soften with weathering and time.

Randal stresses that RACV's brief for Torquay was for an important site. "After all, (it's) No. 1 Great Ocean Road. And it was a commission of real ambition. RACV wanted a building that is looking towards the future, and that was a bold move."

INSIDE RACV TORQUAY RESORT

RACV Torquay Resort is open to every one of RACV's 2.1 million members, their families and guests, who will enjoy savings of 25% on accommodation. It's also open to the general public.

It's the latest in RACV's portfolio of resorts in Victoria and Queensland that strive to offer members premium holiday and leisure facilities in great locations and provide excellent value.

Members already have the choice of quality RACV resorts in popular Victorian holidays areas, at Cape Schanck (Mornington Peninsula), Inverloch (Gippsland) and Cobram (Murray River), as well as Royal Pines (Gold Coast) and Noosa in Queensland.

Now RACV Torquay Resort brings the same quality and value within easy reach of members on the western side of Melbourne and in western Victoria, as well as members who come from all over to experience the Surf Coast and the Great Ocean Road.

According to resort manager Dean Newell, he and his staff are going all out to have Torquay "not only to be recognised as an exceptional resort, our intent is to set a whole new benchmark. There are not many resorts like this. The quality pretty much puts it in a place on its own."

Being within such a diverse and productive food growing region, Dean says the resort's main 160-seat restaurant, Number One, will feature local, seasonal produce, presented simply but elegantly. "It will feature some real highlight dishes," he says. With these dining opportunities open to the public as well as staying guests, Dean says: "We want to be recognised for quality local food done well."

At the helm in the kitchen is executive chef Michael Bannerman, who brings to Torquay a wealth of experience from restaurants in London, as well as flagship Melbourne venues such as PM24 and Number 8.

"This region is a goldmine of produce," Michael says. "We will be concentrating on simple, amazing flavours."

"Leisure and lifestyle is another real focus for us," Dean Newell says. "There is a real opportunity to either kick back and relax, or be as active as you like."

Here is what members can expect at RACV Torquay Resort.

The accommodation

There are 92 spacious rooms and suites. Many of them inter-connect for family-style accommodation. The 3m ceilings allow for broad picture windows with stunning coastal views.

The dining

Number One Restaurant is the signature restaurant at RACV Torquay Resort, where the high-class menu has an emphasis on locally sourced ingredients. For instance, food and beverage manager Andre Smaniotto, who has experience in hotels everywhere from France and Scotland to Tahiti, has devised eight different dishes using Portarlington mussels.

For more casual dining, there's White's Paddock bistro and bar, which includes a range of "old pub favourites".

The golf course

The 18-hole traditional links-style golf course is being extensively redeveloped by Ogilvy Clayton, a Melbourne design team headed by former U.S. Open champion Geoff Ogilvy and Mike Clayton, winner of many Australian and overseas tournaments.

There will also be a short course/practice area – ideal for just a few holes.

Conferences and events

Banquet facilities at Torquay can cater for 270 seated guests. It's the ideal place for a wedding, anniversary or birthday celebration, gala dinner, awards night or any corporate event.

It can also be used for conferences, seating up to 340. There are 10 auxiliary rooms for meetings or smaller conferences.

One Spa

Members don't have to stay at the resort to book into the One Spa facility, where they will be pampered in the spa and sauna rooms as well as in the Turkish hammam-style steam room.

The spa also provides plunge pools and relaxation rooms, all finished in earthy tones to complement the resort's ambience.

Activity

Resort guests can enjoy the One Lifestyle fitness centre, which includes a state-of-the-art health club with 40 pieces of cardio equipment, resistance training machines, free weights and functional training equipment. There's a group fitness studio and the RPM spin/cycle studio.

The resort has a 25m heated indoor pool, an aquatic exercise area with wheelchair access, and two floodlit tennis courts.

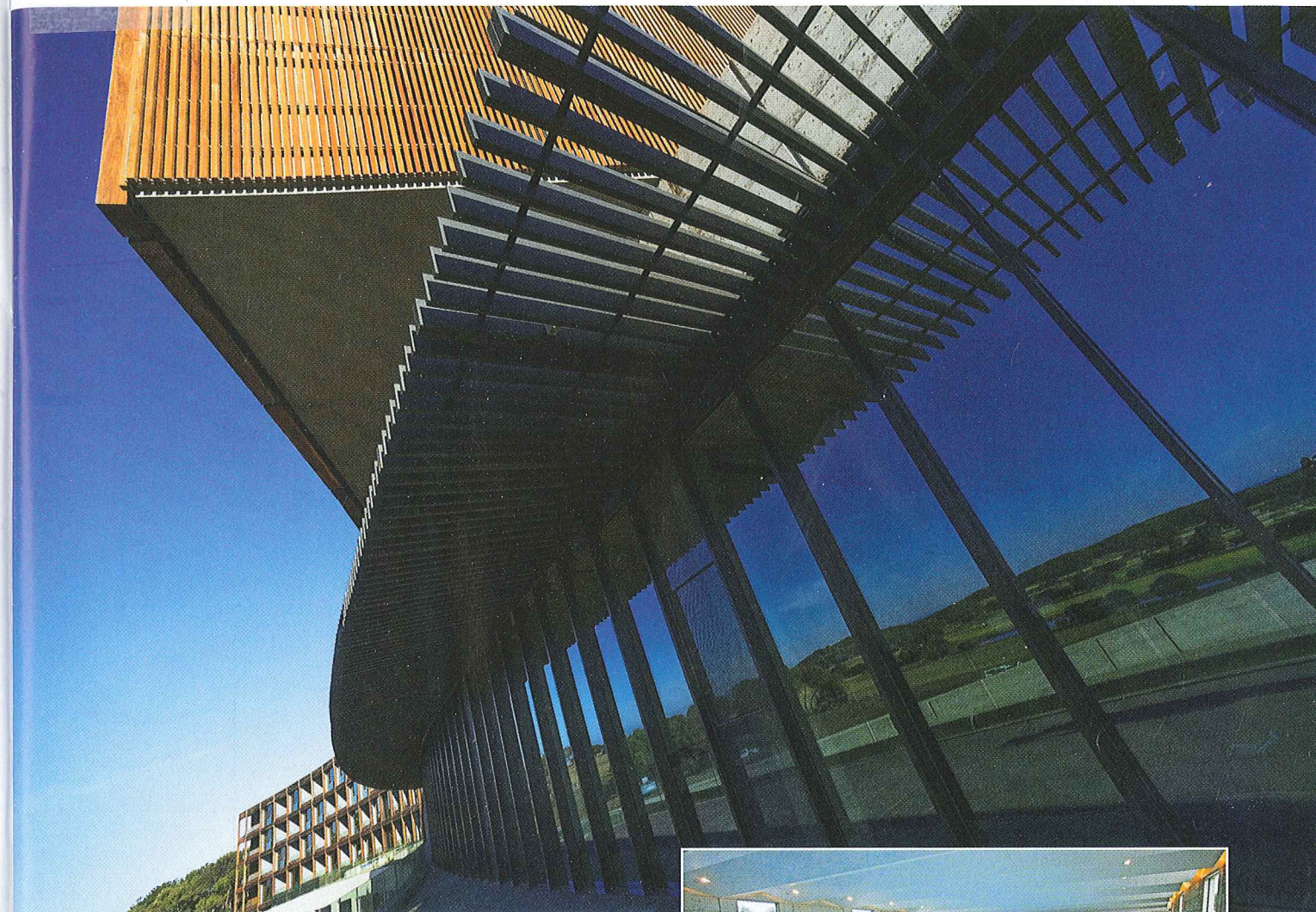

Others wishing to access these fitness facilities can buy a One Lifestyle membership.

There's easy access to scenic coastal walking and cycling trails, and you can walk to patrolled surf beaches at Torquay and Jan Juc, each just 1.2km away.

Parking

There are 337 car parking spaces, 187 of them undercover, and 50 bicycle spaces.

The environment

Besides the low-impact design of its high-insulating rammed-earth construction, the entire resort has been designed to be respectful of its position and the environment.

Rain water is harvested from the roof for internal use, substantial remedial and re-vegetation works on the golf course have eradicated weeds and non-native trees. The landscaping will include more than 200,000 new native plants.

The creation of a wetlands on the golf course will support the area's flora and fauna biodiversity.



STAY & SAVE

RACV Torquay Resort is open for members and their guests, offering you great-value accommodation, dining and more. Members can enjoy RACV Torquay Resort from just \$195 per night, including breakfast for two.

Members also receive substantial discounts on golf and One Spa treatments. One Lifestyle fitness membership is \$1050 a year, and RACV Years of Membership Benefits discounts apply. For more information and to book, go to racv.com.au/resorts, or call RACV Torquay Resort on 5261 1600.

And members can show their RACV card and save at a host of retail partners in and around Torquay. To find out more, go to racv.com.au/sycas and follow the Save in Regional Victoria link.